

Panzer

User Guide

HD-01



Panzer®

Panzer Kenet Makinaları Tic. Ltd. Şti.

Yenidogan Mah. Abdi Ipekci Cad.

Cizmeci Is Merkezi No:87/75

Bayrampaşa / Istanbul

+90 531 818 64 41

www.panzerkenet.com

ozgur@panzerkenet.com

May, 2024

Contents

1. Safety Precautions
 - 1.1 General Safety Reminders
 - 1.2 Safety Precaution for This Machine
 - 1.3 Safety Precaution for Electricity
 - 1.4 Lifting
2. Machine Specifications
3. Overall Drawing
4. Main Units
5. Requirements of Power Source
6. Operations
7. Maintenance
8. Electric Diagram
9. Programmable Counter User Manual

1. Safety Precautions

1.1 General Safety Reminders

- ✓ The operator to operate the machine should be properly trained.
- ✓ Operation of the machine should not contradict with the instructions in operation manual.
- ✓ Keep the machine and work area neat, clean and orderly.
- ✓ Do not store any articles around the machine that will impede the safety of the operation.
- ✓ The operator operating the machine should wear safety glasses to protect the eyes.
- ✓ Do not work with long hair that can be caught injury by the machine, tie it up at the back or wear a hat.
- ✓ After drinking alcohol or if the body is not in good condition, do not operate or maintain the machine.
- ✓ Do not touch the turning part of the machine with hands or body.
- ✓ Do not touch the turning part of the machine with handtools or the other article.
- ✓ Do not open the electrical cabinet, wire terminal or any other protection covers.

1.2 Safety Precaution for This Machine

This machine is provided with a number of safety devices to protect personal and equipment from injuries and damages. So, the operator must fully understand what special precautions to take.

It is assumed that the operator has been properly trained, has the requisite skill and is authorized to operate the machine. The following safety regulations which should be observed:

- ✓ Before operating the machine, be sure people who are not operating the machine are kept away from the area which may cause danger during machine running.
- ✓ Before operating the machine the operation manual should be perused, contact the manufactory for more details, if anything is unclear.
- ✓ Please follow the instructions of the operation manual to check and maintain the machine.

- ✓ Don't take off any protection covers or interlock functions.
- ✓ Before starting the machine, be sure of the ways to can stop the machine in case of emergency.
- ✓ Before starting the machine, be sure which function will be executed after pressing the push button on the machine.
- ✓ Don't clean or load/unload the workpiece while motor is running.

1.3 Safety Precaution for Electricity

- ✓ The required electrical source for the machine is 220V / 110V AC 1 Phase.
- ✓ All maintenance and adjustment related with the electrical control should be executed by properly trained personal.
- ✓ Before opening the electrical cabinet, the main power should be turned off.
- ✓ Before replacing the electrical elements, be sure the power has been turned off.
- ✓ To avoid turning the power on during the maintenance, put a warning plate in front of the machine.
- ✓ During the maintenance, be sure the power has been turned off and use tools with insulated material.
- ✓ Before turning on the power after completing the maintenance, be sure there is nobody on the machine for any operation.
- ✓ Install an earth connection and connect to the machine, if there is no earth connection in public electrical source.
- ✓ Electric leakage or a malfunction may occur if liquid enters electric parts of the machine. Do not splash the machine whit liquid when clean, etc.

1.4 Lifting

For to lift with a crane, the machine must be connected to this point with lifting rope.



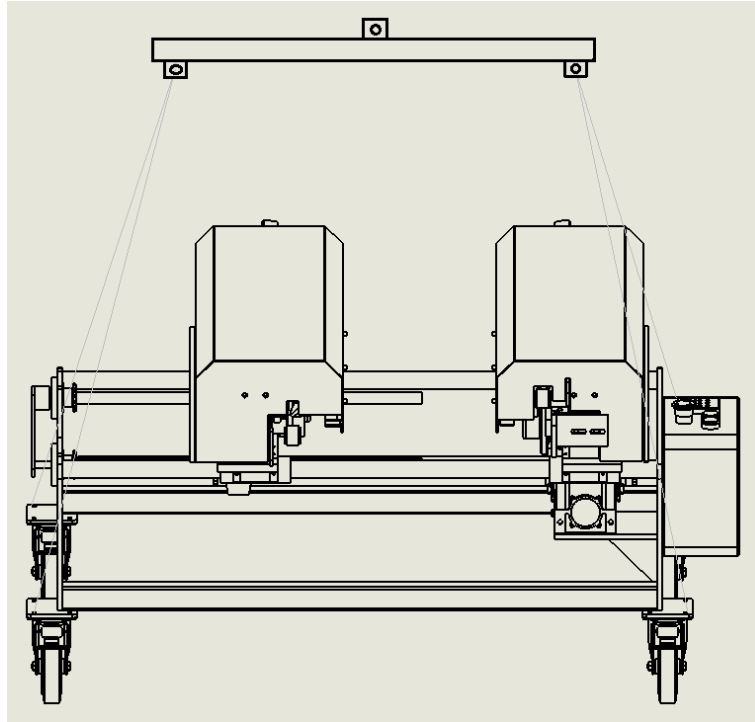

2. Machine Specifications

Panzer Knt is a portable standing seam roofing machine. The machine has eight stations. Eleven degrees profiling occurs in all stations. The machine can profiling metal, aluminum, titanium zinc ve copper sheets. The working range of the machine is between 250 mm and 700 mm. Parallel sheet metal is produced in a single work cycle. Tapered sheet metal panels are produced in 2 work cycles. The machine is movable on four wheels. Electric motor is 1.1kW 1400 rpm.

See Fig.1 for panel dimensions

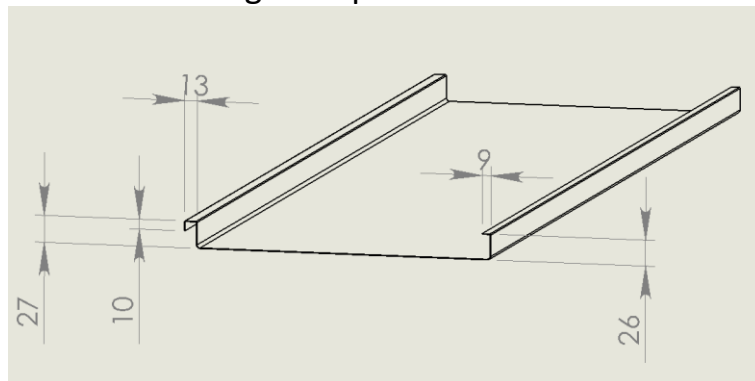
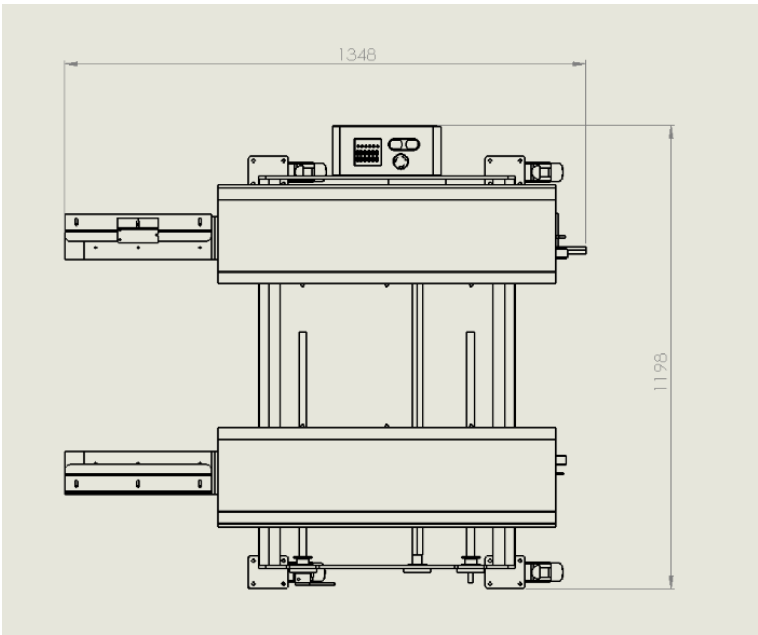
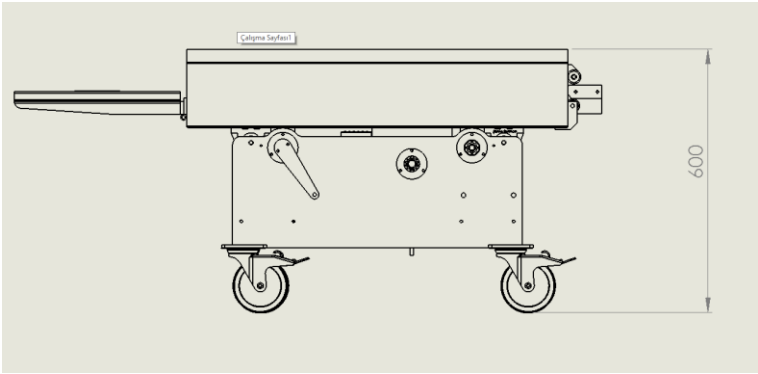

Fig. 1 - Panel Dimensions

3. Overall Drawing



4. Main Units

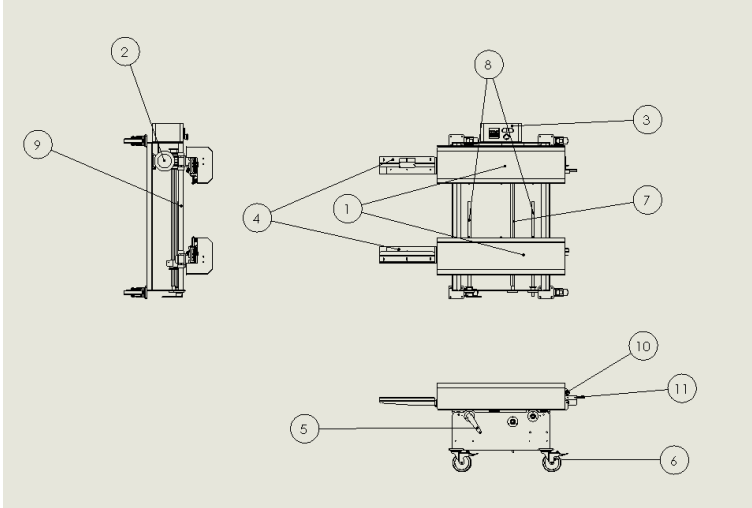

Fig. 2 - Name of Parts and Units

No	Name
1	Covers
2	Electric Motor
3	Electric Cabinet
4	Input Arms
5	Distance Adjustment
6	Wheel
7	Shaft
8	Threaded Rod
9	Slide
10	Output Roll
11	Steepness Adjustment

5. Requirements of Power Source

The machine works with 1-Phase AC 110/220V 50/60 Hz.

Must be grounded before giving power. The wire should be selected depending on the machine. Cable size must be 2.5 mm² or more. The cable should not be longer than 25 meters. If the distance is more than 25 meters, cable thickness should be increased.

6. Operations



The Machine comes to you with packed like picture.

Before start with power ON, you should adjustment like follows:

First, you should take of input arms.



Then, you should mount both input arms like follows



For this, you should unscrew the bolts by hand

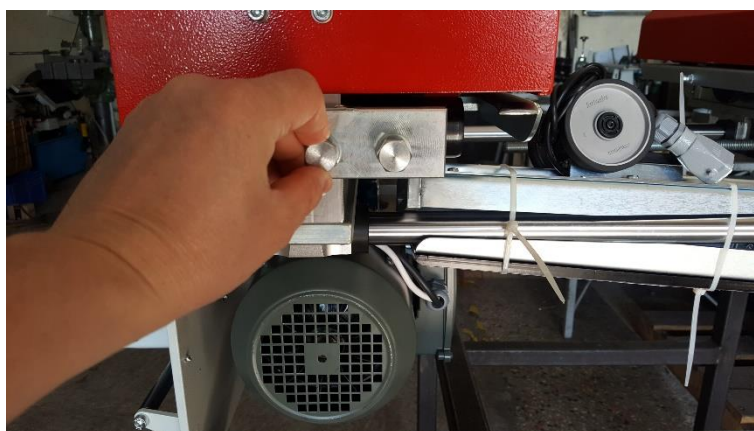

Arms should come to the zero point

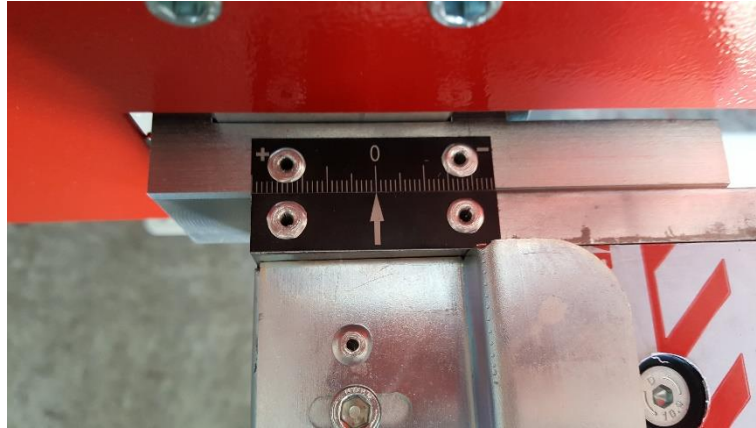

Then, you should screw the bolt by wrench number seventeen.

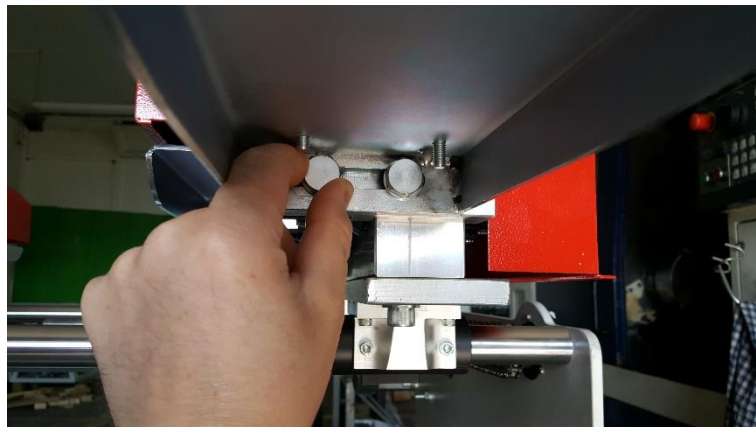

Finally, insert the encoder socket

We should make same adjustment for the both input arms. If there is a problem with the settings made up to this point, the panel will be manufactured incorrectly. So, we can continue after all these settings are done well.

After, you can input sheet metal from the left side. Then you move the right side

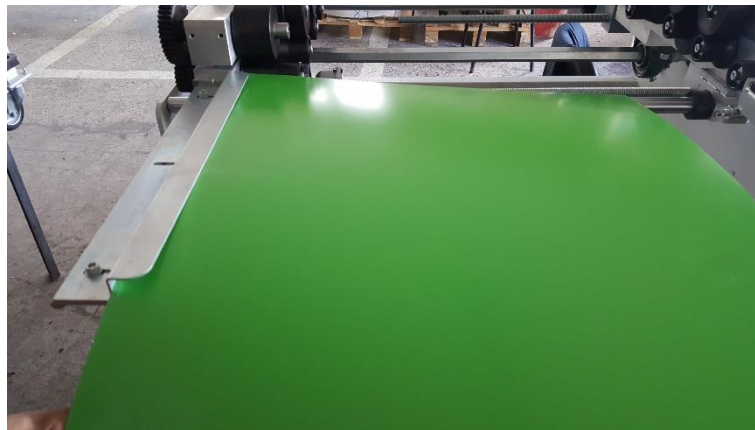

As a result, all edges must touch the input arms. You can see followings.

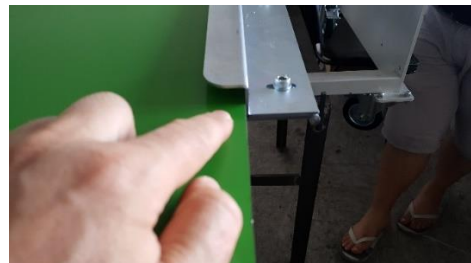

Finally, you should turn on pacco switch. Later you can press the power button.



7. Maintenance

- ✓ The following parts should be cleaned and lubricated at regular intervals.
- ✓ Gear wheels must be lubricated with grease.
- ✓ Chain gears must be lubricated with oil.

Important Notes:

- ✓ Please do not leave any materials between the rolls as they cause the coating on the rollers to deteriorate.
- ✓ Please do not operate the machine in the rain.
- ✓ Protect the machine from water

8. Electric Diagram

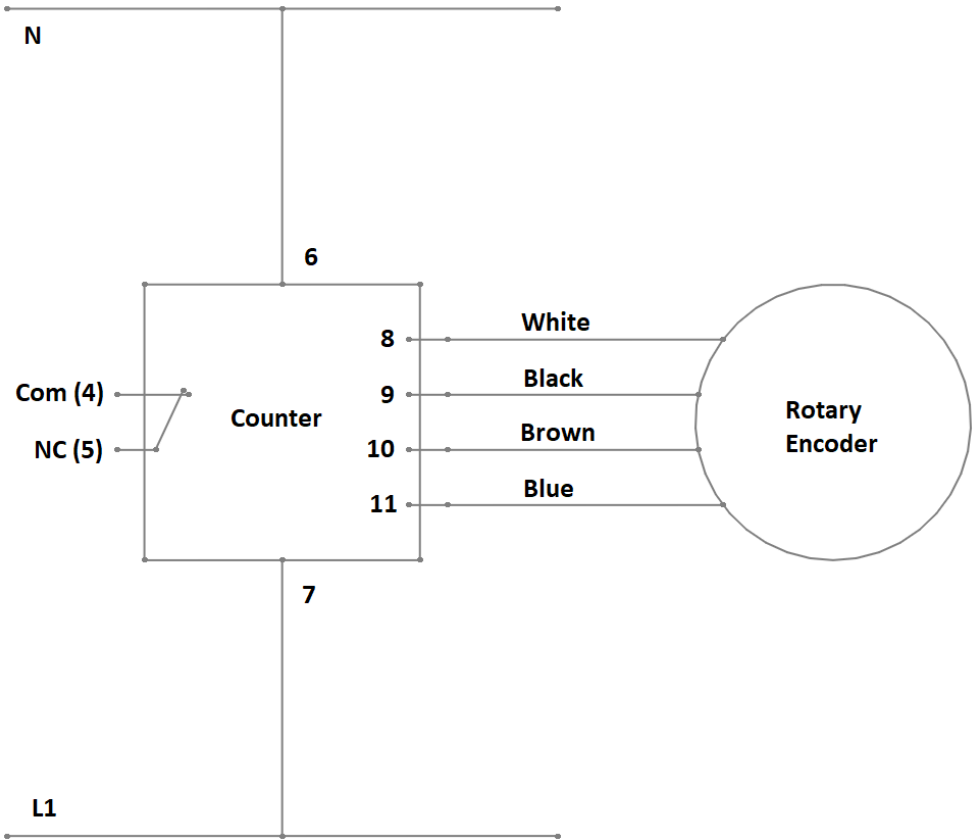
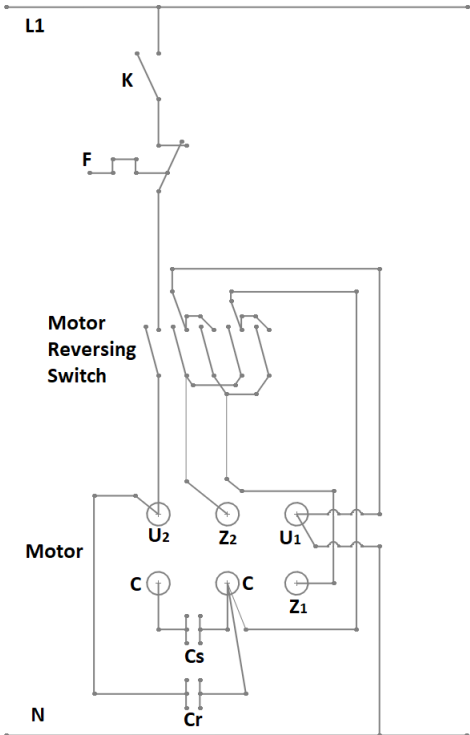
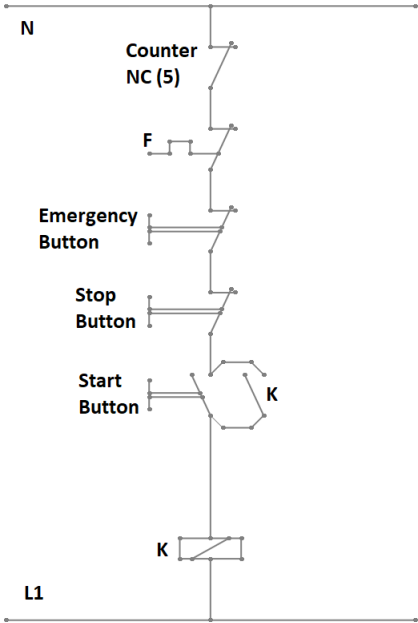

9. Programmable Counter User Manual

Programmable Counter/Timer

Operations and functions

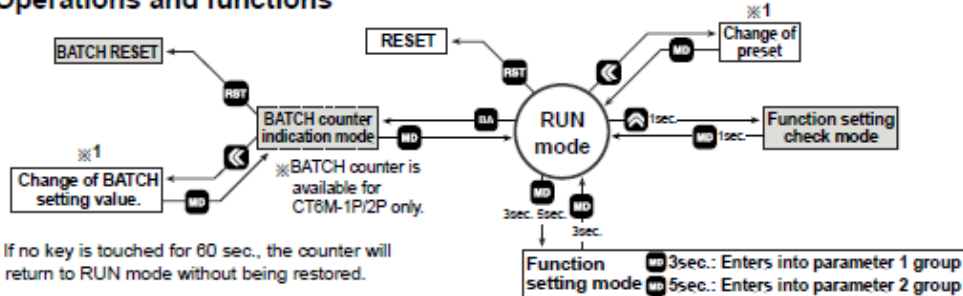

※1. If no key is touched for 60 sec., the counter will return to RUN mode without being restored.

Change of preset(Counter/Timer)

- Even if changing the preset value, input operation and output control will continue. In addition, the preset value could be set to 0 and 0 preset value turns ON. According to output mode, preset value could not be set to 0. (When setting to 0, preset value "0" will flash 3 times.)

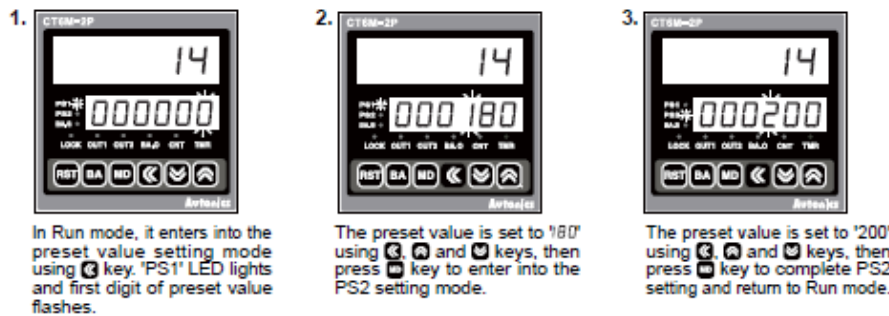

※ Press MD key to save set value after changing the setting value. Then, it moves to next parameter or returns to RUN mode. However, if no key is touched for 60 sec., it will return to RUN mode without being saved.

Function setting check mode

- Setting value of function setting mode can be confirmed using the BA and MD keys.

Switching display function in preset indicator

- Setting value 1(PS1) and setting value 2(PS2) are displayed each time pressing MD key in dual preset model. (In timer, it is available for *and*, *and I*, *and2* output mode.)

Reset

- In Run mode or function setting mode, if RST key or applying the signal to the RESET terminal on the back side, present value will be initialized and output will maintain off status. When selecting voltage input(PNP), short no. 10 and no. 12 terminals, or when selecting no-voltage input(NPN), short no. 11 and no. 12 terminals to reset.

BATCH Counter(For CT6M-1P□□ /CT6M-2P□□ model only)

In BATCH counter indication mode, 'BATCH counter value' is displayed in count indicator and 'BATCH counter setting value' is displayed in preset indicator.

Change of BATCH setting value

If pressing MD key in Run mode, it will enter into BATCH counter indication mode.

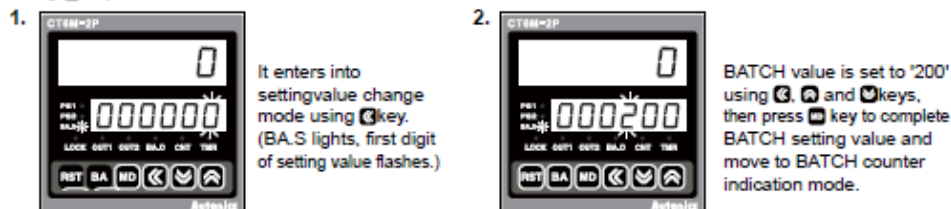

(A)	Photo electric sensor
(B)	Fiber optic sensor
(C)	Door/Area sensor
(D)	Proximity sensor
(E)	Pressure sensor
(F)	Rotary encoder
(G)	Connector Socket
(H)	Temp. controller
(I)	SSR/ Power controller
(J)	Counter
(K)	Timer
(L)	Panel meter
(M)	Tachol/ Speed/ Pulse meter
(N)	Display unit
(O)	Sensor controller
(P)	Switching mode power supply
(Q)	Stepper motor& Drive&Controller
(R)	Graphic/ Logic panel
(S)	Field network device
(T)	Software
(U)	Other



CGS TEST HİZMETLERİ TEKNİK KONTROL VE
BELGELENDİRME ANONİM ŞİRKETİ

Oruçreis Mahallesi Tekstilkent Caddesi Tekstilkent
A21 10/I 102 Esenler İstanbul/TURKİYE
Deney Raporu
Test Report



AB-1316-T

AB-1316-T

LVD-333-01

04-19

Müşterinin Adı / Adresi: ÖZGÜR ÜNAL / YENİDOĞAN MAH. ABDİ İPEKÇİ CAD. ÇİZMECİ İŞ MERKEZİ NO: 87 İÇ KAPI
Customer name / Address NO: 75 BAYRAMPAŞA/ İSTANBUL

İstek Numarası: 02042019ebb1
Order no.

Numunenin Adı ve Tanımı: HD-01 ; KENET MAKİNESİ – STANDING SEAM MACHINE
Name and identity of test item

Numunenin Kabul Tarihi: 2019-04-04
The date of receipt of test item

Açıklamalar: DGC'ye TS EN 60204-1 Standardı uyarınca Güvenlik Deneyleri yapılmıştır.
Remarks Safety tests have been applied to EUT according to TS EN 60204-1.

Deneyin Yapıldığı Tarih: 2019-04-04
Date of Test

Raporun Sayfa Sayısı: 9 sayfa / pages
Number of pages of the Report

Deney laboratuvarı olarak faaliyet gösteren CGS TEST HİZMETLERİ, TÜRKAK'tan AB-1316-T ile TS EN ISO/IEC 17025 Nisan 2012 standardına göre akredite edilmiştir.

CGS TEST HİZMETLERİ accredited by TÜRKAK under registration AB-1316-T for TS EN ISO/IEC 17025 April 2012 as test laboratory.
Türk Akreditasyon Kurumu(TÜRKAK) deney raporlarının tanınırlığı konusunda Avrupa Akreditasyon Birliği(EA) ile Çok Taraflı Anlaşma ve Uluslararası Laboratuvar Akreditasyon Birliği(ILAC) ile karşılıklı tanıma anlaşması imzalamıştır.

Turkish Accreditation Agency (TURKAK) is a signatory to the European co-operation for Accreditation (EA) Multilateral Agreement (MLA) and to the International Laboratory Accreditation Cooperation (ILAC) Mutual Recognition Arrangement (MRA) for the recognition of test reports.

Deney ve /veya ölçüm sonuçları, genişletilmiş ölçüm belirsizlikleri (olması halinde) ve deney metotları bu sertifikanın tamamlayıcı kısmı olan takip eden sayfalarda verilmiştir.

The test and/or measurement results, the uncertainties (if applicable) with confidence probability and test methods are given on the following pages which are part of this report.

Mühür/Kaşe
Seal



Tarih
Date

2019-04-09

Deney Sorumlusu
Person in charge of test

Timur GÜSER

Onaylayan
Approval

Timur GÜSER

Bu rapor laboratuvarın izni olmadan kısmen kopyalanıp çoğaltılamaz.
İmzasız ve mühürsüz raporlar geçersizdir.

This report shall not be reproduced other than in full except with the permission of the laboratory.
Testing reports without signature and seal are not valid

AB-1316-T

LVD-333-01

04-19

EN 60204-1	
Safety of machinery – Electrical equipment of machines	
Part 1: General requirements	
Report reference No./ Test rapor No	LVD-333-01
Date of issue / Veriliş Tarihi	2019-04-09
Total number of pages / Toplam sayfa sayısı:	9 pages
Testing Laboratory / Test Laboratuvarı.....	CGS TEST HİZMETLERİ TEKNİK KONTROL VE BELGELENDİRME ANONİM ŞİRKETİ
Address / Adres.....	Oruçreis Mahallesi Tekstilkent Caddesi Tekstilkent A21 10/102 Esenler İstanbul/TURKİYE
Testing location / Test Yeri.....	ÖZGÜR ÜNAL
Address / Adres.....	YENİDOĞAN MAH. ABDİ İPEKÇİ CAD. ÇİZMECİ İŞ MERKEZİ NO: 87 İÇ KAPI NO: 75 BAYRAMPAŞA/ İSTANBUL
Applicant's Name / Başvuran Adı.....	ÖZGÜR ÜNAL
Address / Adres.....	YENİDOĞAN MAH. ABDİ İPEKÇİ CAD. ÇİZMECİ İŞ MERKEZİ NO: 87 İÇ KAPI NO: 75 BAYRAMPAŞA/ İSTANBUL
Test specification/Test özellikleri	
Standard/Standart.....	EN 60204-1:2006/AC:2010
Test procedure/Test prosedürü	Type Test/Tip Testi
Non-standard test method/Standart olmayan test yönetimi	N/A
Test Report Form No. / Test Rapor Form No:	F510_02_R3.0
Test item description / Test numunesi açıklaması	KENET MAKİNESİ – STANDING SEAM MACHINE
Manufacturer / Üretici.....	ÖZGÜR ÜNAL
Trademark / Marka	
Model and/or type reference / Model ve/ yada tip referansı.....	HD - 01
Rating(s) / Değer(ler).....	110-220V AC; 50-60Hz ; 1,3kW



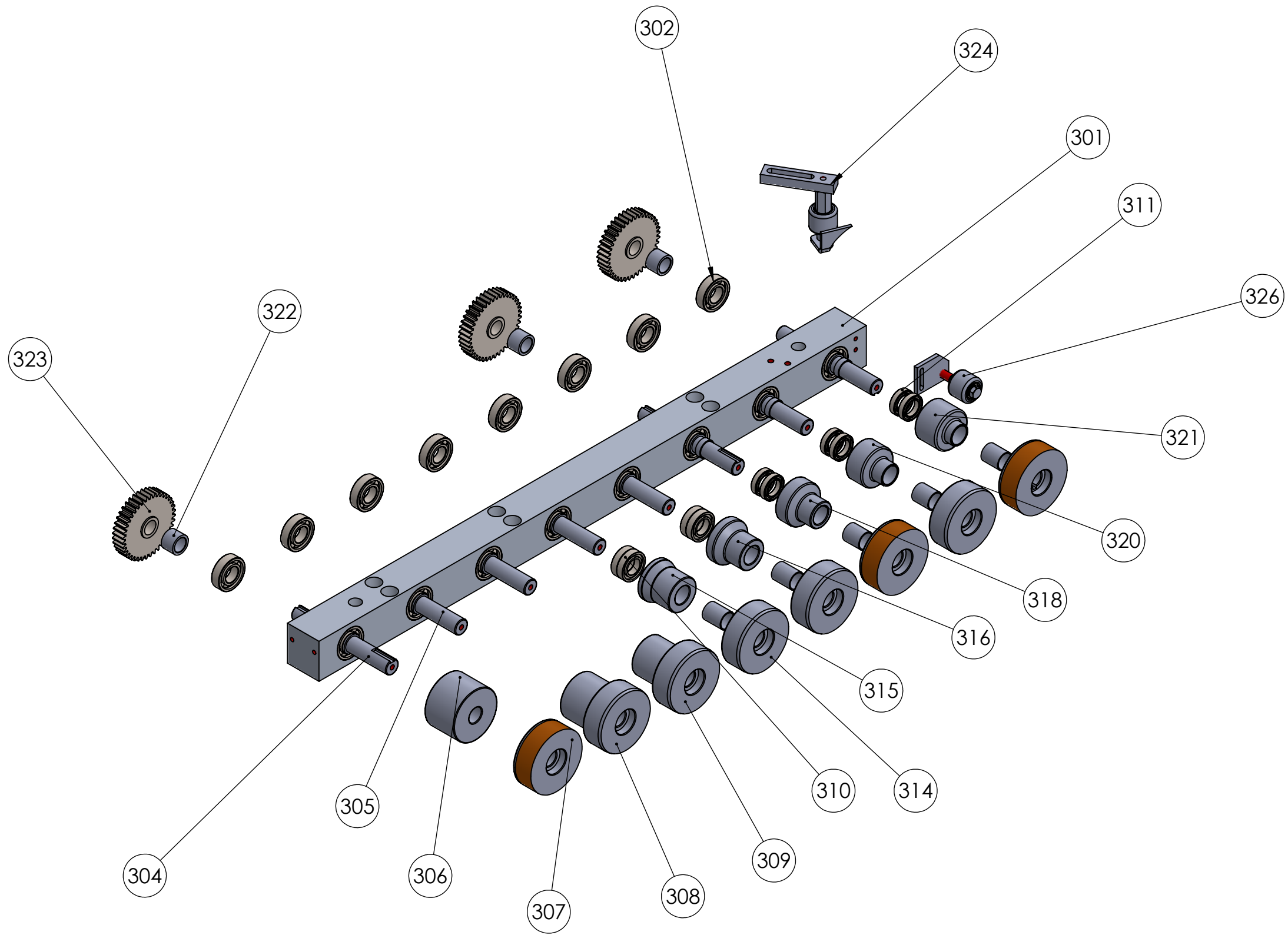

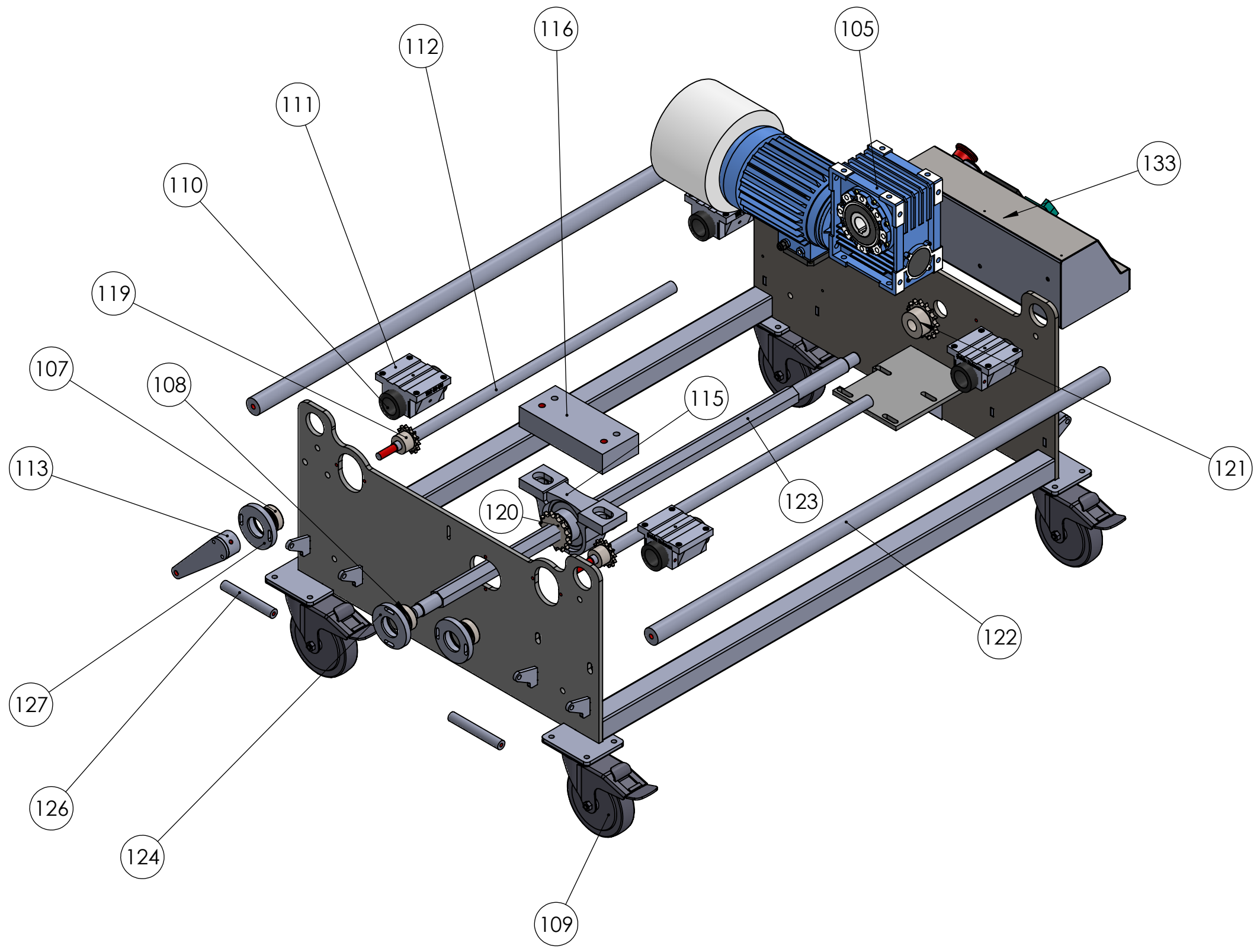

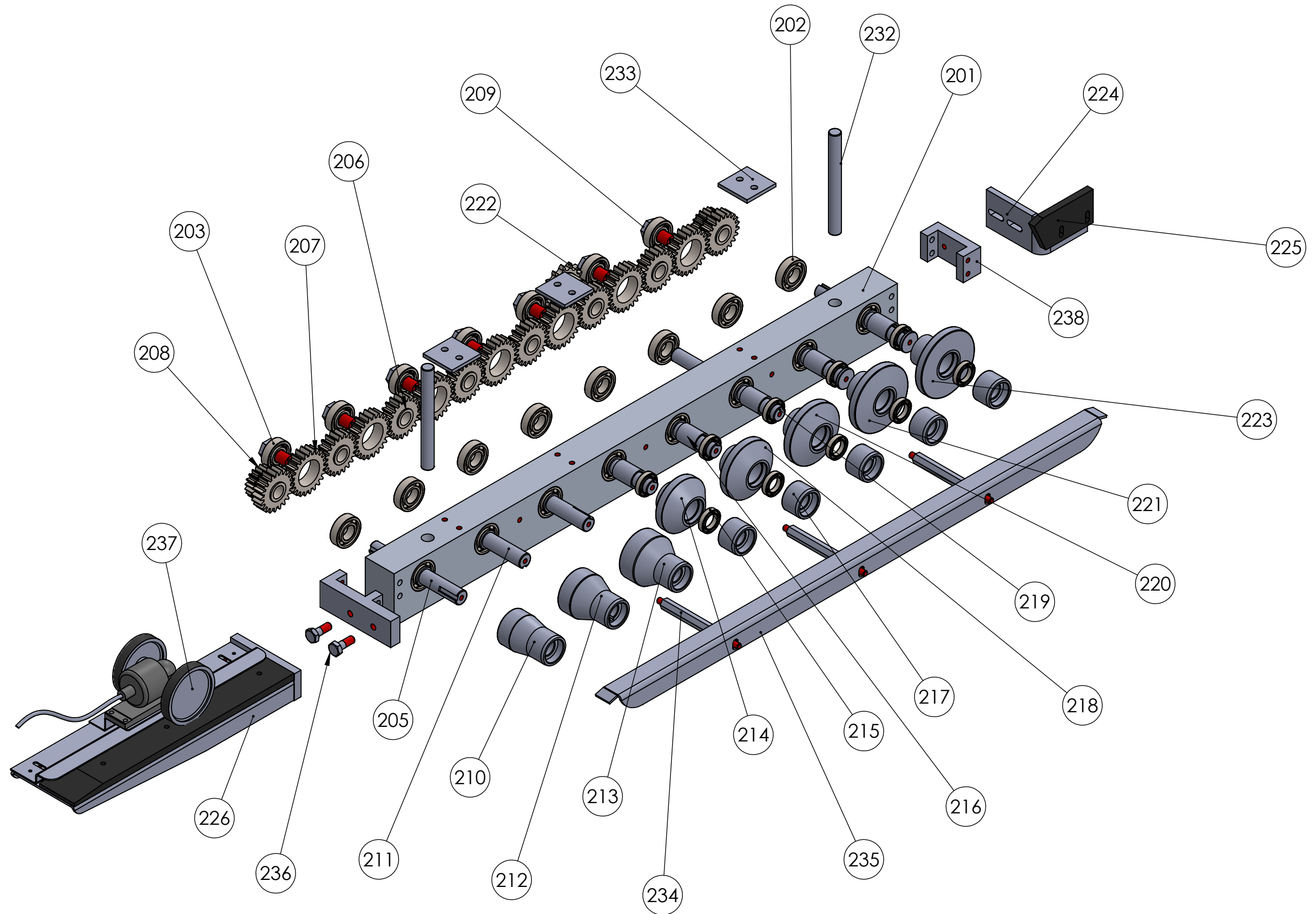

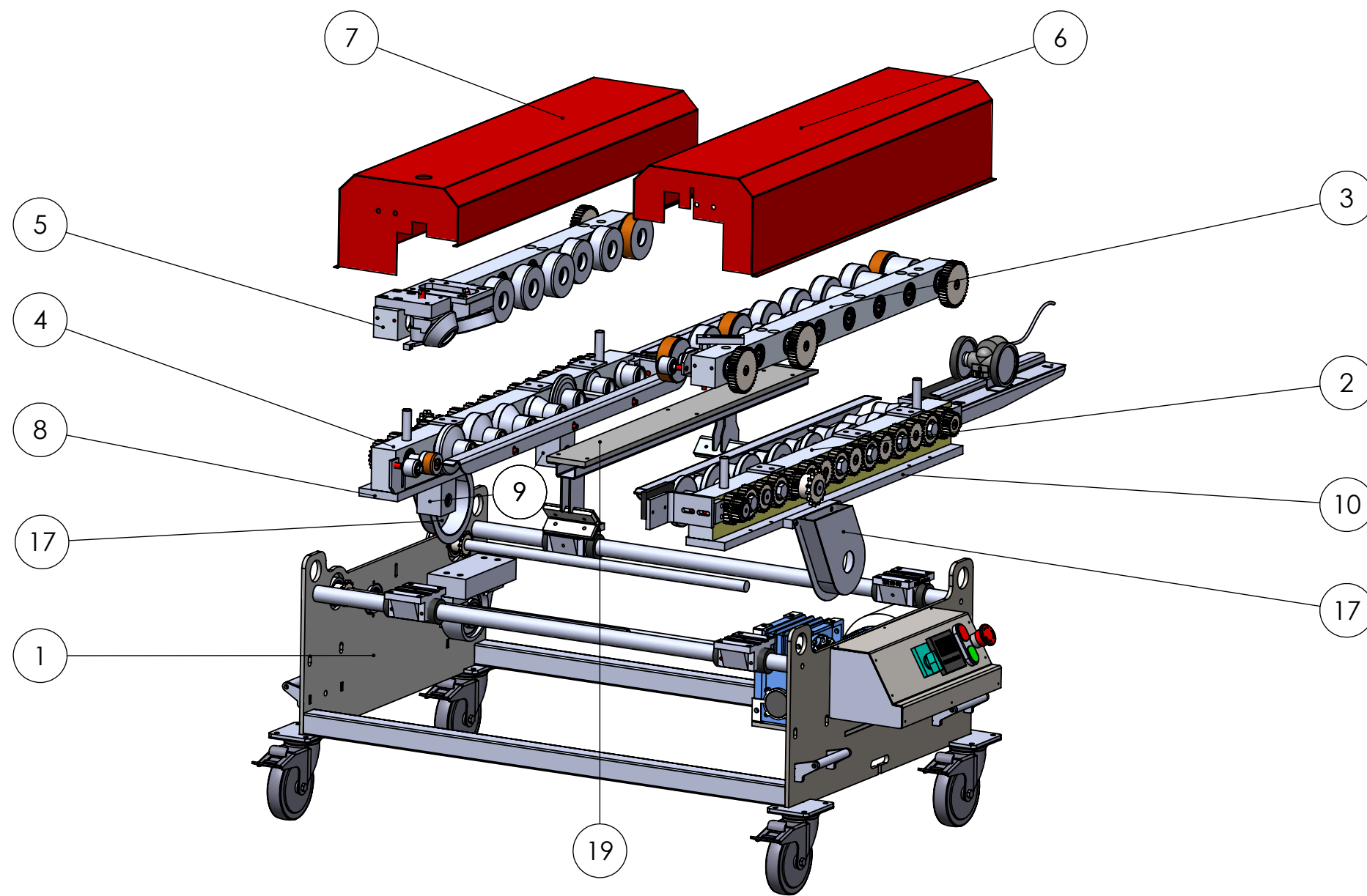

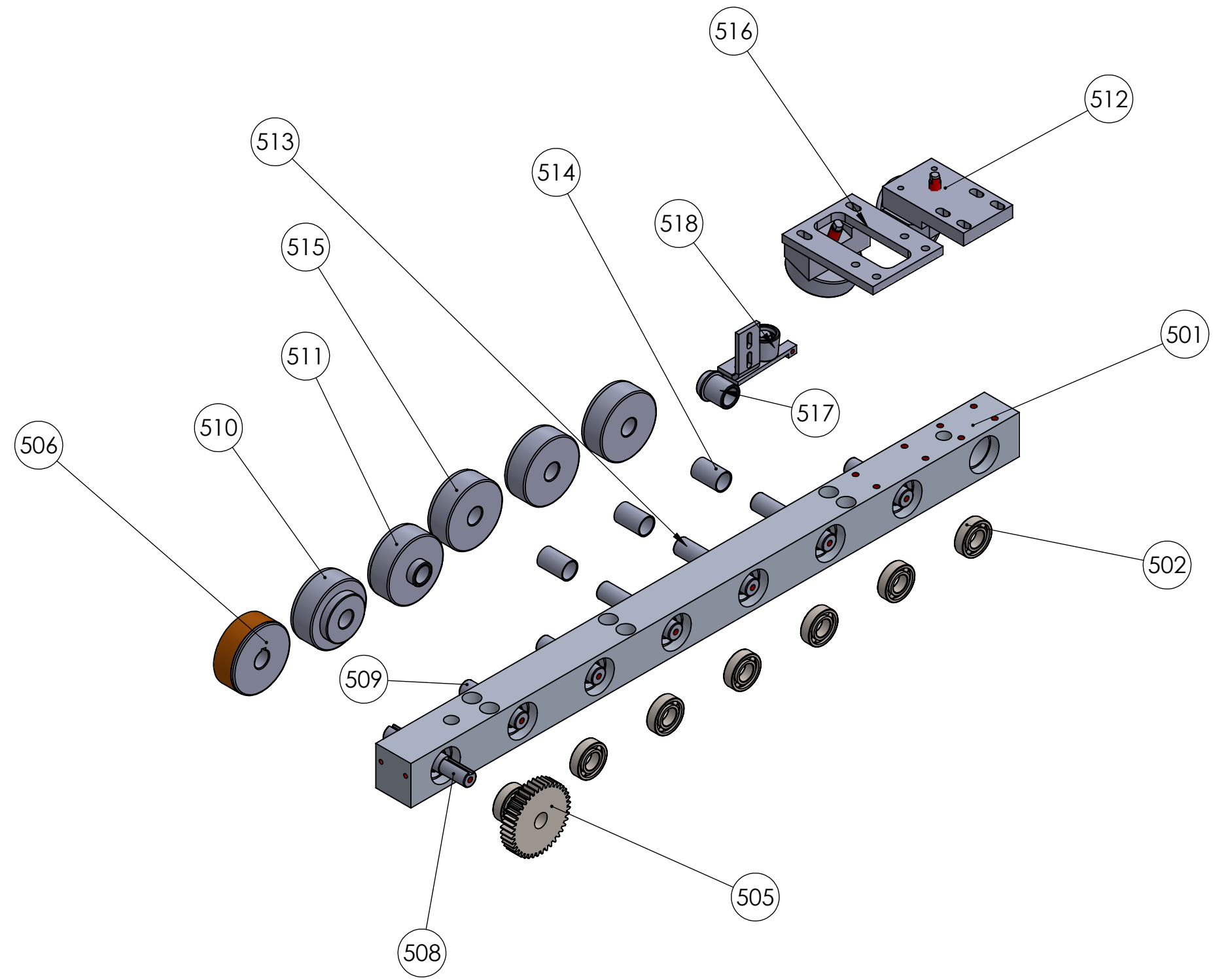

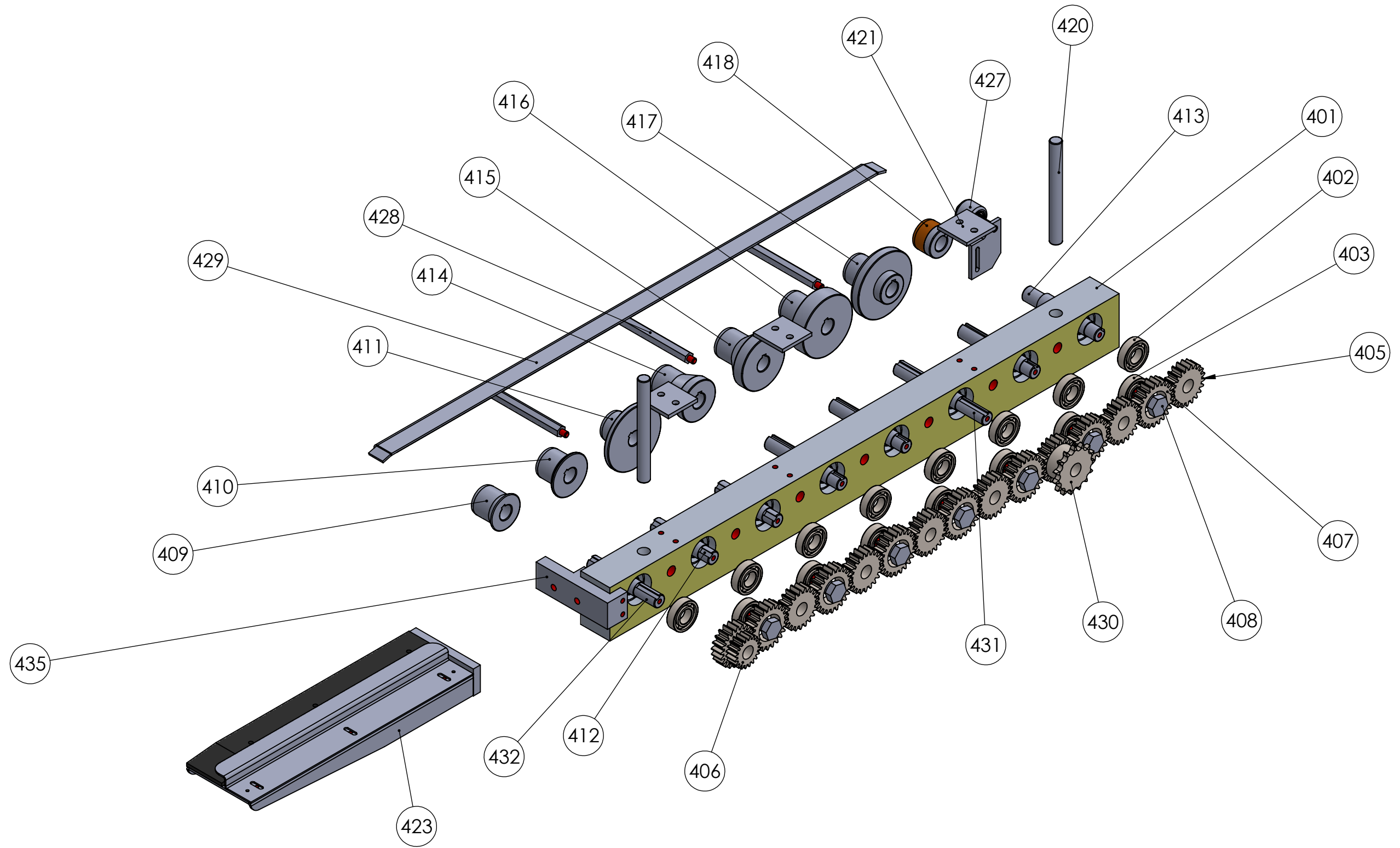

ITEM NO.	PART NUMBER	QTY.
301	SUB_Kutuk	1
302	6004 Bearing	16
304	SAB_Mil1	3
305	SUB_Mil2	5
306	SUB_MP1	1
307	SUB_Mak1	3
308	SUB_Mak2	1
309	SUB_Mak3	1
310	6904 Bearing	4
311	6804 Bearing	6
314	SUB_Mak4	3
315	SUB_MP4	1
316	SUB_MP5	1
318	SUB_MP6	1
320	SUB_MP7	1
321	SUB_MP8	1
322	2M_40_Yuzuk	3
323	Spur Gear 2M 40T	3
324	Hiz_Mak_Montaj	1
326	SU_Son_Des_Mak_Polyamid	1

ITEM NO.	PART NUMBER	QTY.
105	63_Govde_Reduktor	1
107	6302 Bearing	2
108	6004 Bearing	1
109	6002SLB125	4
110	Lineer_Mil_Delrin	4
111	TBR-30-UU	4
112	M20_Tij	2
113	Cevirme_Kolu_Gobegi	1
115	UCP208	1
116	UCP208_Alt_Plaka	1
119	Chain Wheel	2
120	Chain Wheel	1
121	Chain Wheel	1
122	Lineer_Mil	2
123	Reduktor_Mil	1
124	flanş2	1
126	Kulp_Mili	4
127	flanş	2
134	Operator Panel	1

ITEM NO.	PART NUMBER	QTY.
201	SAB_Kutuk	1
202	6004 Bearing	16
203	6203 Bearing	7
205	SAB_Mil1	2
206	Spur Gear 2.5M 21T	8
207	Spur Gear 2.5M 23T	7
208	Spur Gear 2M 20T	3
209	2,5M_Vida	7
210	SAB_Mak1	1
211	SAB_Mil2	5
212	SAB_Mak2	1
213	SAB_Mak3	1
214	SAB_Mak4	1
215	6804 Bearing	10
216	SAB_Mak4_Yuzuk	5
217	SAB_MMP	5
218	SAB_Mak5	1
219	SAB_Mil6	1
220	SAB_Mak6	1
221	SAB_Mak7	1
222	Chain Wheel	1
223	SAB_Mak8	1
224	SAB_SCAD	1
225	SAB_SCADP	1
226	G_Sol_Kulak	1
232	16_Pim	2
233	Kutuk_Pleyti	3
234	Sac_Yatak_Mili	3
235	Sac_Yatak	1
236	Giris_Kolu_Civatasi	2
237	ENC-1-2-T-24	1
238	Cikis_LU	1

ITEM NO.	PART NUMBER	QTY.
1	Sase_Montaj	1
2	SAB_Montaj	1
3	SUB_Montaj	1
4	HAB_Montaj	1
5	HUB_Montaj	1
6	Makara_Ana_Sac_Montaj	1
7	Makara_Ana_Sac_Sol_Montaj	1
8	Taban_Plate	1
9	HAB_CKS	2
10	Taban_Plate2	1
17	Koruma_Kapak	2
19	Ara_Yatak	1

ITEM NO.	PART NUMBER	QTY.
501	HUB_Kutuk	1
502	6004 Bearing	14
505	Spur Gear 2M 40T	1
506	SUB_Mak1	1
508	HUB_Mil1	1
509	HUB_Mil2	3
510	HUB_Mak2	1
511	HUB_Mak3	1
512	HUB_Mak4	2
513	HUB_Mil5	3
514	HUB_Mak5_Yuzuk	3
515	SUB_Mak4	3
516	HUB_Mak7_UM	1
517	HUB_Mak7	1
518	HUB_Mak8	1

ITEM NO.	PART NUMBER	QTY.
401	HAB_Kutuk	1
402	6004 Bearing	16
403	6203 Bearing	7
405	Spur Gear 2.5M 21T	8
406	Spur Gear 2M 20T	1
407	Spur Gear 2.5M 23T	7
408	2,5M_Vida	7
409	HAB_Mak1	1
410	HAB_Mak2	1
411	HAB_Mak3	1
412	HAB_Mil2	2
413	HAB_Mil4	4
414	HAB_Mak4	1
415	HAB_Mak5	1
416	HAB_Mak6	1
417	HAB_Mak7	1
418	HAB_Mak8	1
420	16_Pim	2
421	Kutuk_Pleyti	3
423	G_Sag_Kulak	1
427	SU_Son_Des_Mak_Polyamid	1
428	Sac_Yatak_Mili	3
429	Sac_Yatak	1
430	Chain Wheel	1
431	HAB_Mil6	1
432	HUB_Mil1	1
435	G_Sag_Kulak_Baglanti	1